

3RD FORM EXTRA PRACTICE 4

1- Match



map

library

supermarket

bank

bus station

cinema

bridge

square

castle

café

sports centre





2- Match the words with the pictures.

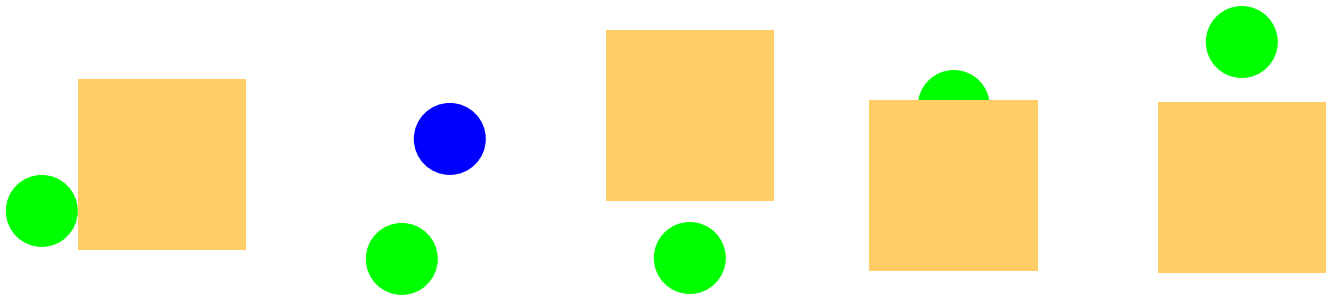

- opposite
- between
- above
- on
- in
- next to
- in front of
- below
- near

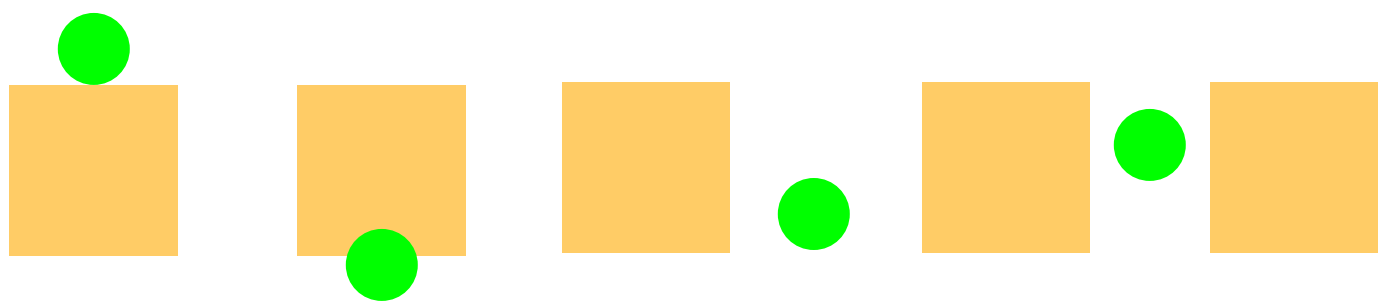

3- Read and draw

Emma is back from the market. Look at all the food! The carrots are near Emma. The bread is between the milk and the bananas. The pears are between the tomatoes and the bananas.

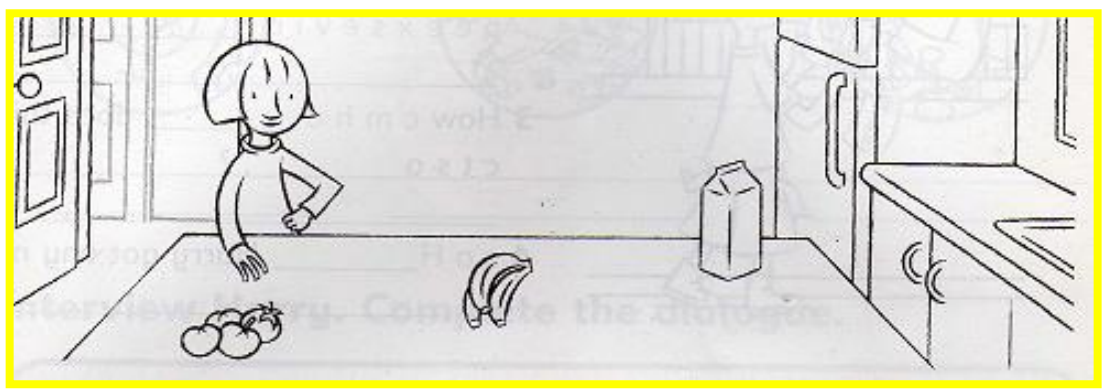

4- Look and complete the sentences.

next to

opposite

between

1 The rabbit is _____ the big dog and the small dog.

2 The bird is _____ the black cat.

3 The white cat is _____ the small dog.

4 The big dog is _____.

5 The black cat is _____.

6 The small dog is _____.

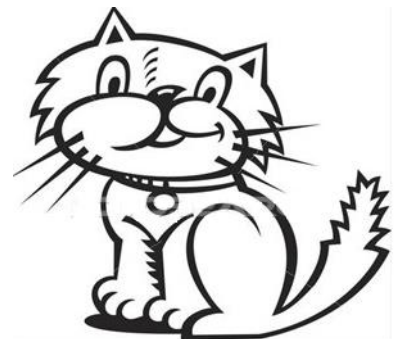



5- Read the sentences and label the school rooms.

1. The gym is between the entrance and John's classroom.
2. The principal's office is opposite the gym.
3. The cafeteria is opposite the entrance.
4. The library is opposite John's classroom.
5. The computer room is next to the library.
6. The art room is opposite the computer room.

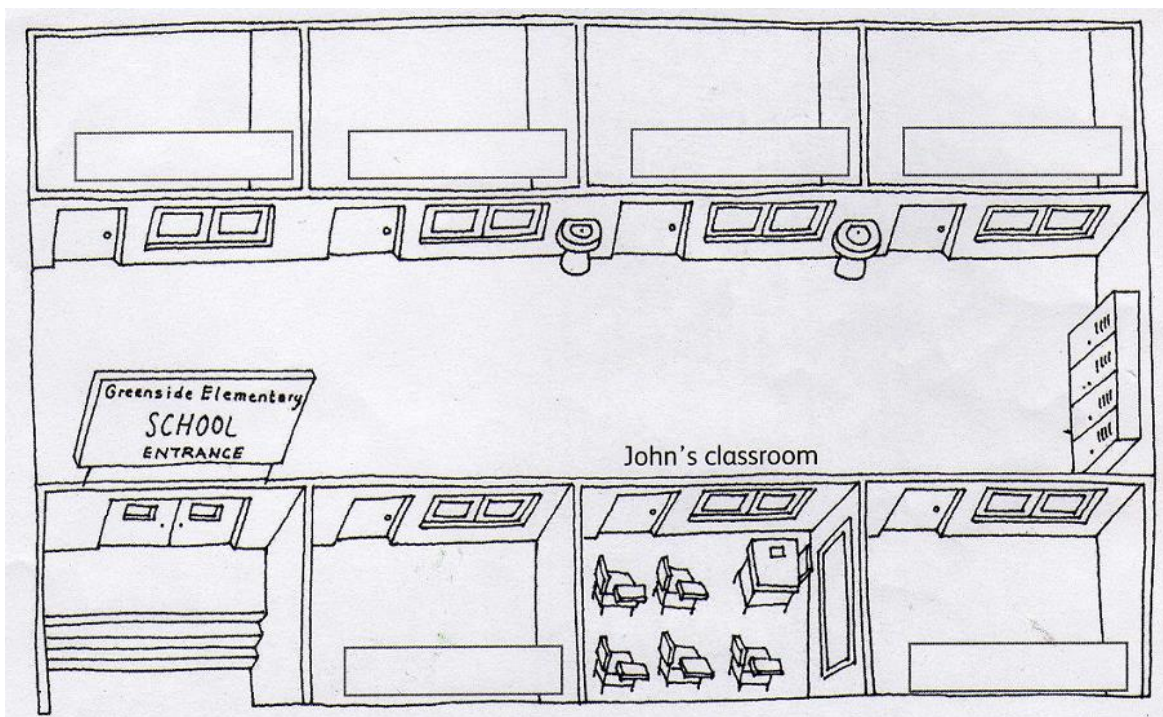

Complete the sentences.

1. The principal's office is _____ the cafeteria.
2. John's classroom is _____ the gym and the _____.
3. The library is _____ the computer room.
4. The gym is _____ the principal's office.



6- Listen and draw lines.

computer room library classroom auditorium gym
cafeteria principal's office entrance art room

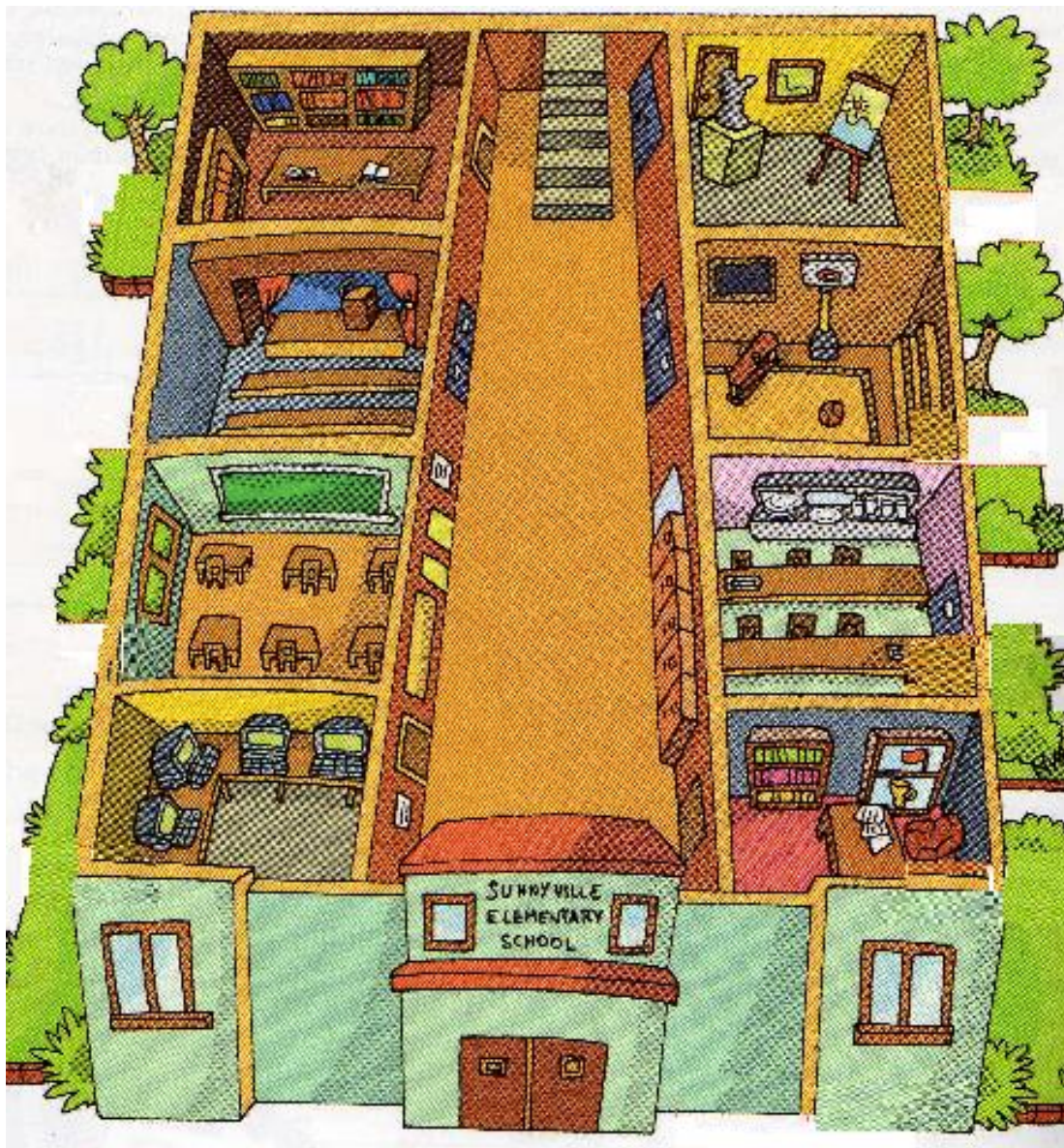



7-Write the questions and answers.

1. a. the me where's excuse square

Excuse me, where's the square?

b. bank opposite it's the

2. a. is where music shop the

b. and between sports centre it's the the library

3. a. bus station for I'm the looking

b. park next the it's to



8- Read and write.

time photos going some to ~~suitcase~~ go take



I'm going to pack my 1. *suitcase*,
I'm going to 2. _____ away.
I'm going to have a great 3. _____,
I'm going on holiday!

I'm going to 4. _____ some sun cream,
And also some shampoo.
I'm 5. _____ to take my toothbrush,
And 6. _____ toothpaste, too.

I'm going to take some 7. _____,
I'm going to see the sea.
I'm going 8. _____ swim and windsurf,
I'm going to waterski!

9- Write sentences with *is*, *isn't*, *are* or *aren't* + *going to*.



1. Alex *is going to take some shampoo.*



2. Emma and Billy _____.



3. Billy _____.



4. Alex _____.

10-Look and complete the questions.

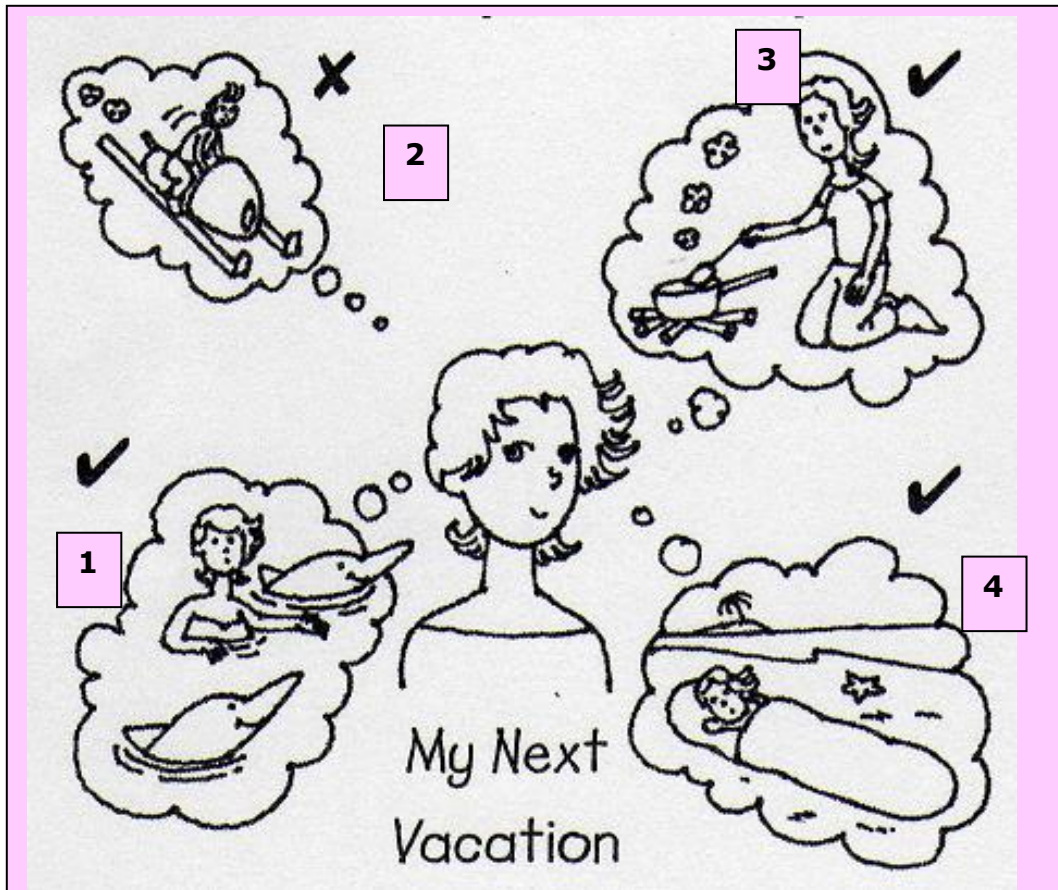

swim with the dolphins cook sleep in a sleeping bag sled

1. Are you going to *swim with the dolphins*?

Yes, I am.

2. Are _____?

_____.

3. Are _____?

_____.

4. Are _____?

_____.

11-Listen and answer the questions.

1. Where is Tony going to spend his vacation?

_____.

2. Why is Frank going to have a party?

_____.

12-Listen again and mark (✓ or X) the pictures. Then complete the sentences.

✓= is going to

X= isn't going to

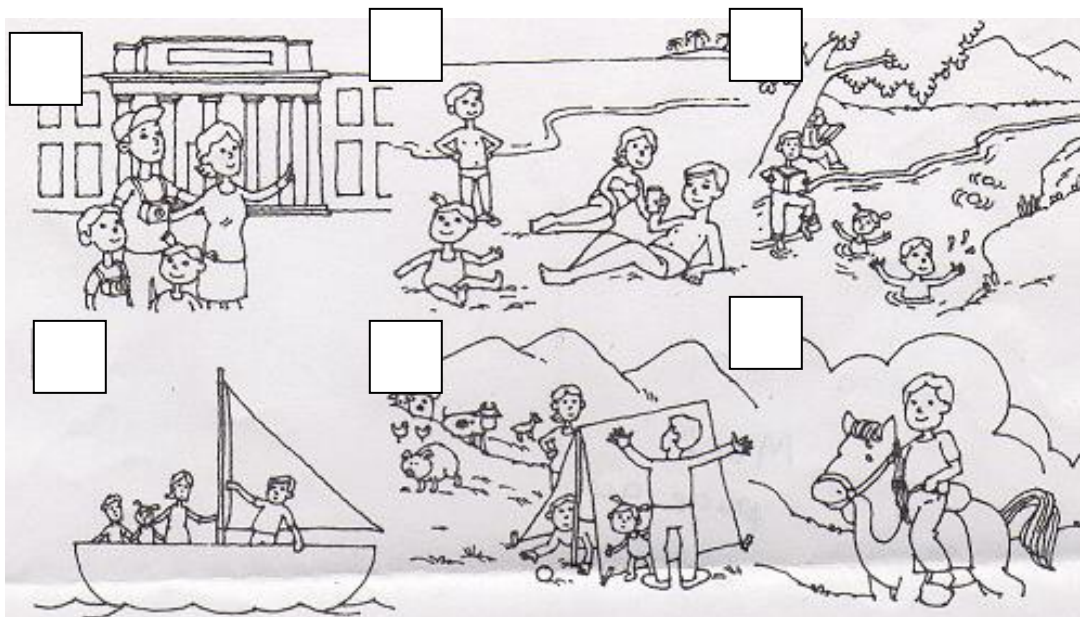

1- Tony _____ visit museums.

2- Tony _____ go to the beach. He _____ go to the mountains.



3- Tony _____ in the river. He _____ go canoeing too.

4- _____ on a farm.
_____. He's afraid of horses!

13- a- Complete the sentences.

8 o'clock Before dinner 7 o'clock After dinner 4:30 After school

Paul gets up at _____.

He has to start school at _____.

He leaves school at _____.

_____, he has to do his homework.

_____, he has to have a bath.

_____, he has to go to bed .





13- b- Now write about you.

Example:

I have to get up at 7 o'clock.

I have to make my bed every day.

3rd EXTRA PRACTICE 4 KEY (Respuestas)

Exercise 1

The diagram consists of ten images on the left and right sides, with ten labels in the center. Colored lines connect each image to its corresponding label:

- map**: Connected to a map showing a path, a river, and trees.
- library**: Connected to a person reading in a library.
- supermarket**: Connected to a person shopping in a supermarket.
- bank**: Connected to a building labeled 'BANK'.
- bus station**: Connected to a person sitting on a bench at a bus station.
- cinema**: Connected to a person sitting in a cinema with popcorn.
- bridge**: Connected to a wooden bridge over a river.
- square**: Connected to a public square with a fountain.
- castle**: Connected to a castle with flags.
- café**: Connected to a cafe counter.
- sports centre**: Connected to a sports stadium.



Exercise 2

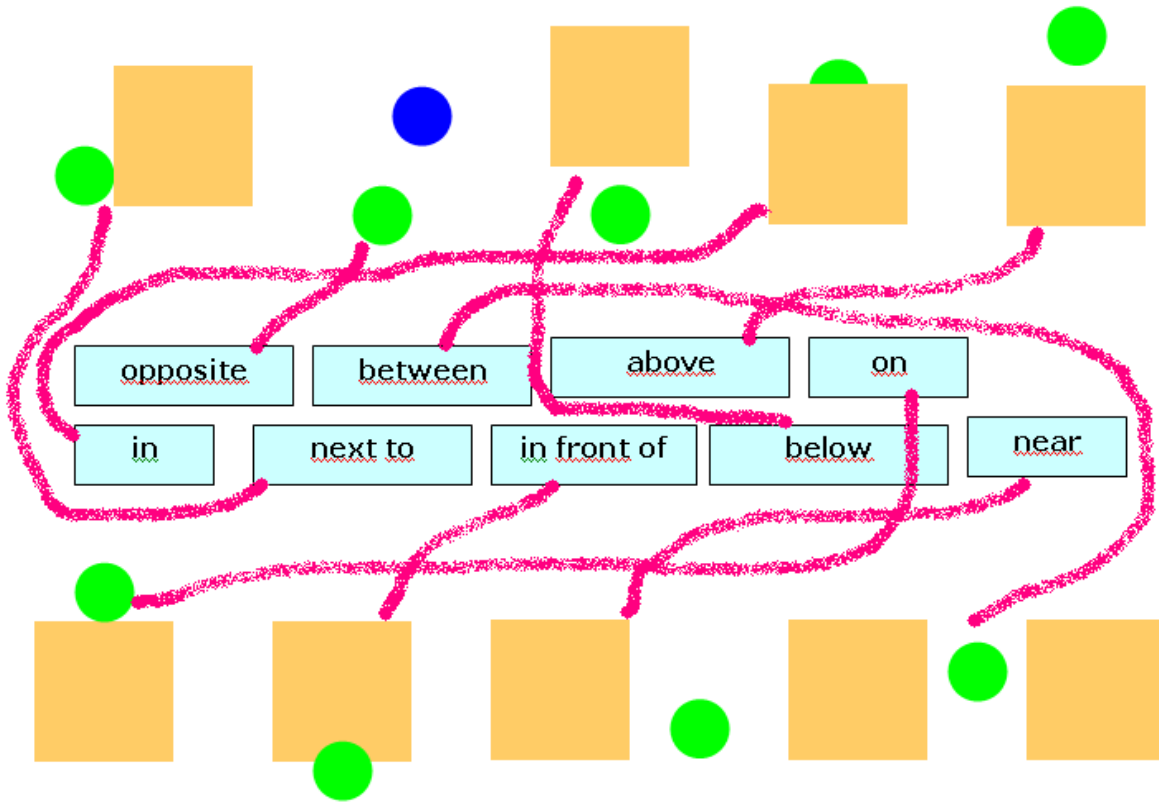

Exercise 3

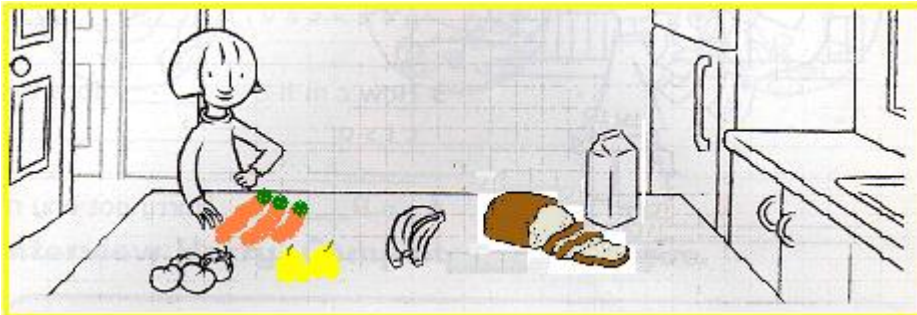



Exercise 4

- 1 The rabbit is **between** the big dog and the small dog.
- 2 The bird is **next to** the black cat.
- 3 The white cat is **opposite** the small dog.
- 4 The big dog is **opposite the bird./next to the rabbit.** (ambas opciones son correctas)
- 5 The black cat is **opposite the rabbit./next to the bird./ next to the white cat./between the bird and the white cat.** (las tres opciones son correcta)
- 6 The small dog is **next to the rabbit./opposite the white cat.** (ambas opciones son correctas)

Exercise 5

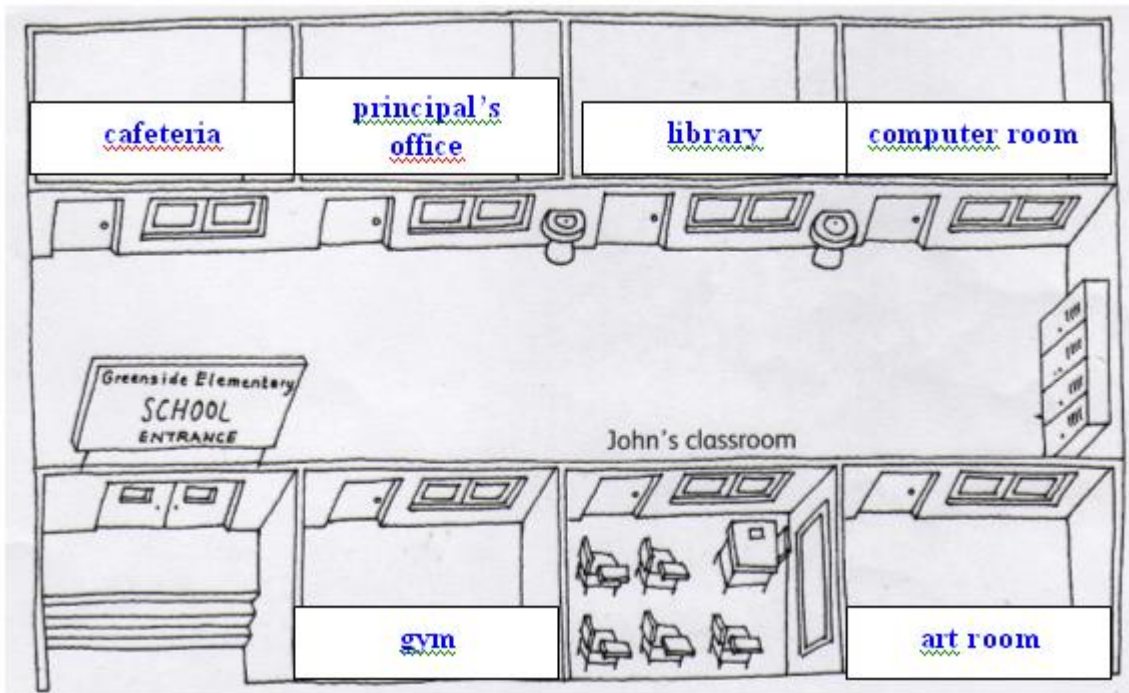

1. The principal's office is **next to** the cafeteria.
2. John's classroom is **between** the gym and the **art room**.
3. The library is **next to** the computer room.
4. The gym is **opposite** the principal's office.

Exercise 6



Exercise 7

1. a. the me where's excuse square
Excuse me, where's the square?

b. bank opposite it's the

It's opposite the bank.



2. a. is where music shop the

Where is the music shop?

b. and between sports centre it's the the library.

It's between the sports centre and the library.

3. a. bus station for I'm the looking

I'm looking for the bus station.

b. park next the it's to.

It's next to the park.

Exercise 8

2. go
3. time
4. take
5. going
6. some
7. photos
8. to

Exercise 9

(possible answers)

3. Emma and Billy are going to take some photos.
4. Billy is going to swim.
5. Alex isn't going to take some sun cream.



Exercise 10

1. Are you **going to** swim with dolphins?

Yes, I am.

2. Are you **going to** sled?

No, I am not.

3. Are you **going to** cook?

Yes, I am.

4. Are you **going to** sleep in a sleeping bag?

Yes, I am.

Exercise 11

1. Where is Tony going to spend his vacation? **Tony is going to go to Spain.**

2. Why is Frank going to have a party? **Because it is Frank's birthday.**

Exercise 12

1- Tony **is going to** visit museums.

2-Tony **is not going to** go to the beach. He **is going to** go to the mountains.

3-Tony **is going to go swimming** in the river. He **is going to** go canoeing too.

4-Tony **is going to stay** on a farm.

Tony is not going to go horseback-riding. He's afraid of horses!



Exercise 13

a-

Paul gets up at 7 o'clock.

He has to start school at 8 o'clock.

He leaves school at 4:30.

After school, he has to do his homework.

Before dinner, he has to have a bath.

After dinner, he has to go to bed.

b-

Open answer (respuesta abierta)